

DP-500^{Q&As}

Designing and Implementing Enterprise-Scale Analytics Solutions Using
Microsoft Azure and Microsoft Power BI

Pass Microsoft DP-500 Exam with 100% Guarantee

Free Download Real Questions & Answers **PDF** and **VCE** file from:

<https://www.leads4pass.com/dp-500.html>

100% Passing Guarantee
100% Money Back Assurance

Following Questions and Answers are all new published by Microsoft
Official Exam Center

- ⚙️ **Instant Download** After Purchase
- ⚙️ **100% Money Back** Guarantee
- ⚙️ **365 Days** Free Update
- ⚙️ **800,000+** Satisfied Customers



QUESTION 1

You have an Azure SQL database named DB1.

You have a Power BI tenant that contains 20 workspaces. Multiple workspaces contain datasets that use DB1 as a data source.

You need to identify how many datasets use DB1 as a data source across the tenant.

What should you use?

- A. an XLMA endpoint
- B. the Power BI REST API
- C. Power BI data source files
- D. lineage view

Correct Answer: D

QUESTION 2

You are optimizing a Power BI data model by using DAX Studio.

You need to capture the query events generated by a Power BI Desktop report.

What should you use?

- A. the DMV list
- B. a Query Plan trace
- C. an All Queries trace
- D. a Server Timings trace

Correct Answer: C

QUESTION 3

From Power Query Editor, you profile the data shown in the following exhibit.

	IoT GUID	IoT DateTime	IoT ID
1	48196321-38D9-EC11-BB3D-0022489A2...	21/05/2022 18:59:25	100001000
2	49196321-38D9-EC11-BB3D-0022489A2...	21/05/2022 18:59:26	100001001
3	0300C742-38D9-EC11-BB3D-0022489A2...	21/05/2022 19:00:21	100001002
4	0400C742-38D9-EC11-BB3D-0022489A2...	21/05/2022 19:00:21	100001003
5	0500C742-38D9-EC11-BB3D-0022489A2...	21/05/2022 19:00:21	100001004
6	0600C742-38D9-EC11-BB3D-0022489A2...	21/05/2022 19:00:21	100001005

The IoT GUID and IoT ID columns are unique to each row in the query.

You need to analyze IoT events by the hour and day of the year. The solution must improve dataset performance.

Solution: You remove the IoT ID column and retain the IoT GUID column.

Does this meet the goal?

- A. Yes
- B. No

Correct Answer: A

QUESTION 4

You have a Power BI tenant that is linked to an Azure AD tenant. The tenant contains a group named Group1.

You create a paginated report that does NOT use row-level security (RLS).

You need to send a copy of the report to Group1 every Monday at 9 AM UTC.

Which two actions should you include in the solution? Each correct answer presents part of the solution.

NOTE: Each correct selection is worth one point.

- A. Create a subscription for Group1.
- B. Publish the paginated report to a Pro workspace.
- C. Create a data alert for Group1.
- D. Publish the paginated report to a Premium Per User workspace.

Correct Answer: AD

QUESTION 5

You have a Power BI workspace named workspace1 that contains three reports and two dataflows.

You have an Azure Data Lake Storage account named storage1.

You need to integrate workspace1 and storage1.

What should you do first?

- A. In storage1, create a folder named dataflows.
- B. Delete the dataflows from workspace1.
- C. In storage1, create a folder named reports.
- D. Delete the reports from workspace1.

Correct Answer: B

QUESTION 6

You are using DAX Studio to analyze a slow-running report query. You need to identify inefficient join operations in the query. What should you review?

- A. the query statistics
- B. the query plan
- C. the query history
- D. the server timings

Correct Answer: B

QUESTION 7

You have a Power BI dataset that has only the necessary fields visible for report development. You need to ensure that only 25 fields are available when end users personalize visuals. What should you do?

- A. From Tabular Editor, create a new perspective.
- B. From Tabular Editor, create a new role.
- C. Hide all the fields in the dataset.
- D. Configure object-level security (OLS).

Correct Answer: A

QUESTION 8

You have a dataset that contains a table named UserPermissions. UserPermissions contains the following data.

User	Region
CONTOSO\User1	1
CONTOSO\User2	2
CONTOSO\User3	1
CONTOSO\User4	3
CONTOSO\User4	5

You plan to create a security role named User Security for the dataset. You need to filter the dataset based on the current users. What should you include in the DAX expression?

- A. [UserPermissions] - USERNAME()
- B. [UserPermissions] - USERPRINCIPALNAME()
- C. [User] = USERPRINCIPALNAME()
- D. [User] = USERNAME()
- E. [User] = USEROBJECTID()

Correct Answer: D

QUESTION 9

You have an Azure Synapse Analytics serverless SQL pool.

You need to catalog the serverless SQL pool by using Azure Purview.

Which three actions should you perform? Each correct answer presents part of the solution.

NOTE: Each correct selection is worth one point.

- A. Create a managed identity in Azure Active Directory (Azure AD).
- B. Assign the Storage Blob Data Reader role to the Azure Purview managed service identity (MSI) for the storage account associated to the Synapse Analytics workspace.
- C. Assign the Owner role to the Azure Purview managed service identity (MSI) for the Azure Purview resource group.

D. Register a data source.

E. Assign the Reader role to the Azure Purview managed service identity (MSI) for the Synapse Analytics workspace.

Correct Answer: BDE

QUESTION 10

You are creating an external table by using an Apache Spark pool in Azure Synapse Analytics. The table will contain more than 20 million rows partitioned by date. The table will be shared with the SQL engines.

You need to minimize how long it takes for a serverless SQL pool to execute a query data against the table.

In which file format should you recommend storing the table data?

A. JSON

B. Apache Parquet

C. CSV

D. Delta

Correct Answer: B

QUESTION 11

You are attempting to configure certification for a Power BI dataset and discover that the certification setting for the dataset is unavailable. What are two possible causes of the issue? Each correct answer presents a complete solution. NOTE: Each correct selection is worth one point.

A. The workspace is in shared capacity.

B. You have insufficient permissions.

C. Dataset certification is disabled for the Power BI tenant.

D. The sensitivity level for the dataset is set to Highly Confidential.

E. Row-level security (RLS) is missing from the dataset.

Correct Answer: BC

Explanation: <https://learn.microsoft.com/en-us/power-bi/collaborate-share/service-endorsement-overview> Reference: <https://docs.microsoft.com/en-us/power-bi/admin/service-admin-setup-certification> <https://docs.microsoft.com/en-us/power-bi/collaborate-share/service-endorse-content>

QUESTION 12

DRAG DROP

You have a shared dataset in Power BI named Dataset1.

You have an on-premises Microsoft SQL Server database named DB1.

You need to ensure that Dataset1 refreshes data from DB1.

Which three actions should you perform in sequence? To answer, move the appropriate actions from the list of actions to the answer area and arrange them in the correct order.

Select and Place:

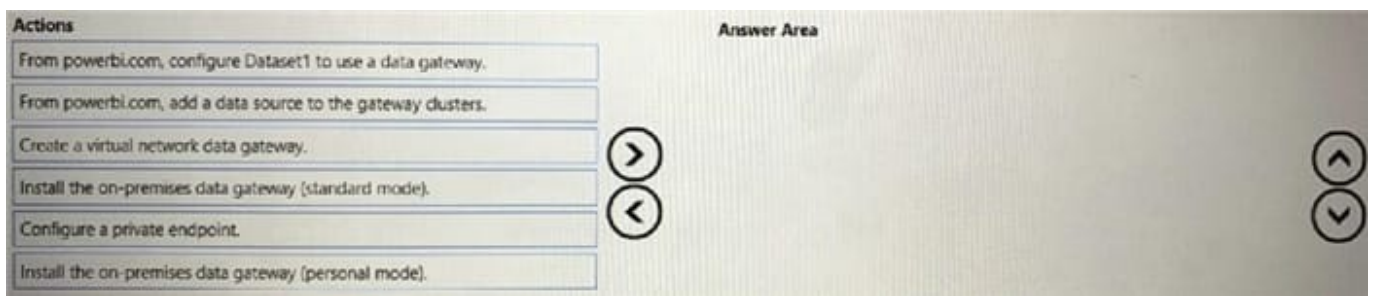

Correct Answer:

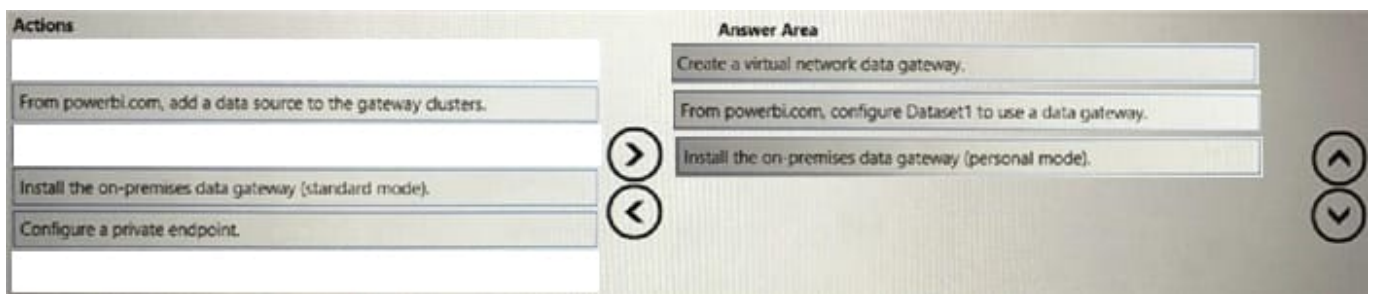

QUESTION 13

You need to save Power BI dataflows in an Azure Storage account.

Which two prerequisites are required to support the configuration? Each correct answer presents part of the solution.

NOTE: Each correct selection is worth one point.

- A. The storage account must be protected by using an Azure Firewall.
- B. The connection must be created by a user that is assigned the Storage Blob Data Owner role.
- C. The storage account must have hierarchical namespace enabled.
- D. Dataflows must exist already for any directly connected Power BI workspaces.

E. The storage account must be created in a separate Azure region from the Power BI tenant and workspaces.

Correct Answer: BC

QUESTION 14

You have the Power BI data model shown in the exhibit (Click the Exhibit tab.) Users indicate that when they build reports from the data model, the reports take a long time to load.

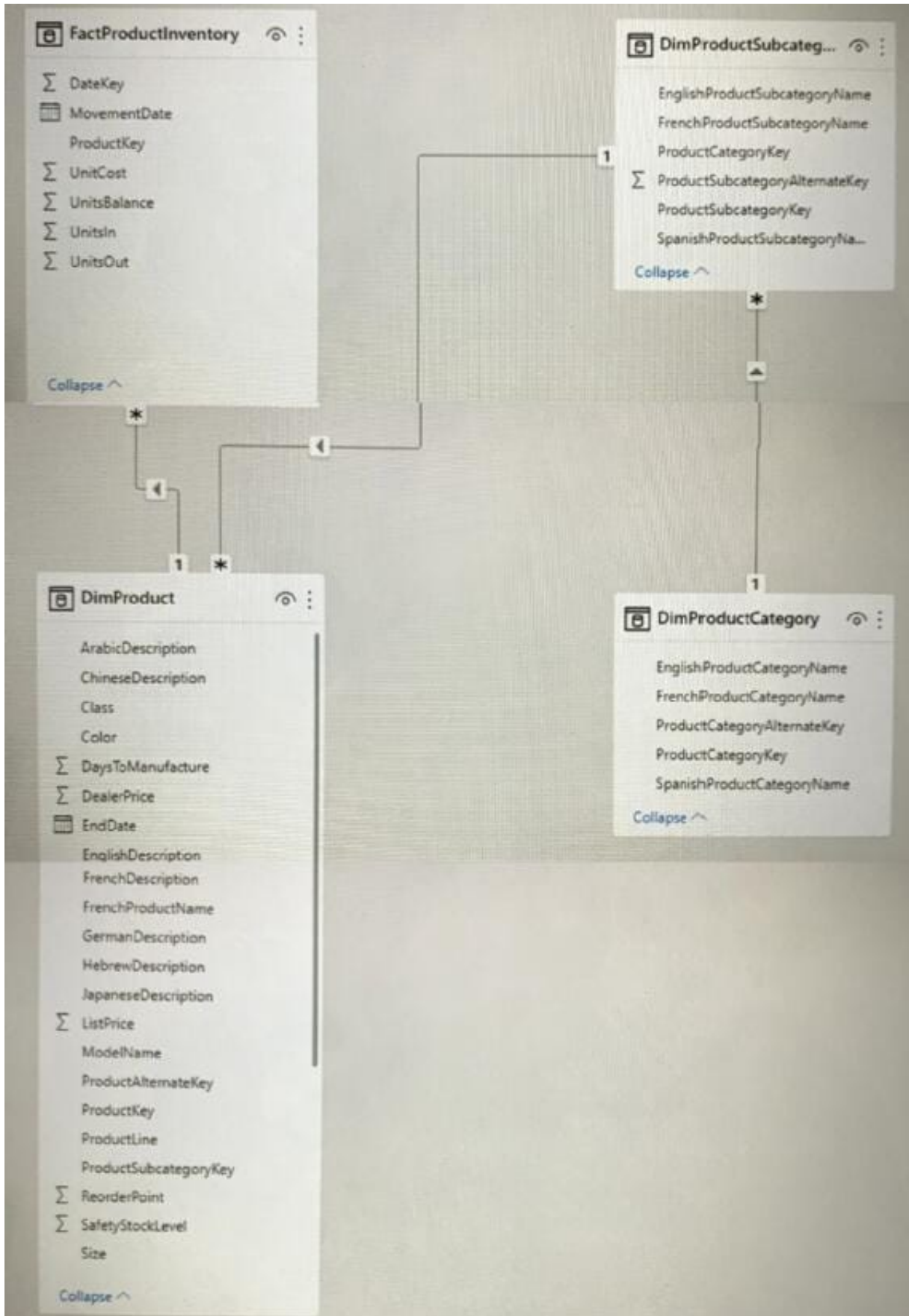

You need to recommend a solution to reduce the load times of the reports.

Solution: You recommend denormalizing the data model. Does this meet the goal?

A. Yes

B. No

Correct Answer: A

QUESTION 15

You have the following code in a cell in an Azure Synapse notebook.

```
# insert command here
new_rows = [('CA', 22, 45000), ('WA', 35, 65000), ('WA', 50, 85000)]
demo_df = spark.createDataFrame(new_rows, ['state', 'age', 'salary'])
demo_df.createOrReplaceTempView('demo_df')
```

You need to replace the comment on the first line of the code with the correct magic command. Which magic command should you use?

A. %%sparkr

B. %%pyspark

C. %%spark

D. %%sql

Correct Answer: B

[Latest DP-500 Dumps](#)

[DP-500 VCE Dumps](#)

[DP-500 Exam Questions](#)